

FITTING INSTRUCTION



CYCLE RACKS

TO ACCOMPANY ALL RISERS PART NUMBER 7271C

PART NUMBER: 7282C / 7283C / 7292C / 7292C

EZI GRIP VERTICAL OR SLANT SPARE TYRE MOUNT BIKE RACK

Thank you for purchasing this quality Ezi Grip accessory. We have taken every effort to ensure this product is manufactured to the highest quality for your complete satisfaction .

If you have any cause to question the workmanship or manufacturing standard please contact your nearest Ezi Grip dealer.

Please read these instructions thoroughly prior to commencing the fitment of this accessory.

For safety reasons it is important that these instructions remain in the glove compartment of your vehicle.

The design of this cycle rack is “generic”. Every attempt has been made to ensure it will fit most vehicle derivatives; however there are some that it will not. It is therefore the express responsibility of the purchaser to ensure the rack is suitable for his/her vehicle. And in addition to ensure the rack is secured safely and not over extended once installed – see specific caution labels on the product.

!!!! MAXIMUM RACK LOAD 75kg !!!!

NOTE: Ensure you have three separately boxed components (Riser Tube, Hanger Tube, Mounting Plate) before you start the installation.

NOTE: Ensure you have the correct mounting plate.

FITTING INSTRUCTIONS

- If your spare wheel is in the centre rear of the vehicle then use Part Number 7281 – Vertical Tyre Mount
- If your spare wheel is offset from the centre rear of the vehicle then use Part Number 7291 – Slant Tyre Mount (this is used to slant the rack so that the bicycles are positioned in the centre of vehicle)

Remove the spare wheel cover if fitted.

NOTE: Once the rack mounting plate is fitted the cover can be reinstalled and when you need to use your rack, simply remove the cover and fix the rack to the mount.

Remove the spare wheel from the rear of the vehicle.

Located the rack’s mounting plate on the spare wheel studs.

NOTE: Normally the mounting plate has the large cut out holes at the top, try to achieve this – it is dependent on your vehicles stud positions.

1. Refit the spare wheel. **NOTE:** Hand tighten all the wheel nuts first, then ensure the rack’s mounting plate is central and positioned as required to fit the rack’s riser tube.
2. Tighten all wheel nuts



Installation Instruction

Offer the riser tube up to the rack's mounting plate. **NOTE:** instruction for tube to be vertical at all times does not apply to slant type mount.

Align and install the threaded rod with the locking knob on one end.

NOTE: Ensure the washer is placed between the knob and the rack's riser tube.

Tighten the knob full so that the rack is safely secured.

Lock the knob.

NOTE: the knob must always be locked once installed, keep the key and spare key in a safe place as the rack cannot be removed without unlocking the knob.



Secure the riser tube with the two additional straps supplied. Lead these straps through a feature hole in the rim, lead them over the riser tube and tighten the straps at the top of the wheel with as much force as possible.



Install the support strap supplied. This can either be done by attaching the hook to a suitable / strong top section of the rear door lip and the other end around and through the d-loop at the top of the riser tube OR by securing the strap around the spare wheel tyre. **NOTE:** if attached to the vehicle body ensure the strap is not over tensioned, this is a support strap only and not designed to carry the full weight of the rack – read the fitting instructions contained in the support straps packaging.

Now fit the hanger tube, clamps and foam pads. Follow the instructions contained in the Hanger Tube Box.

NOTE: When using the slant mount, the clamps will need to be rotated to the horizontal position after the hanger tube has been fitted, follow the instructions in the Hanger Tube Box to do this.

Use additional shock cords when transporting bicycles. Periodically check the tightness of the rack and clamps. Ensure the Ezi-Safety clip is always in place when not using a locking device

**REFER TO THE ATTACHED DRAWING IF ANY INSTRUCTIONS ARE UNCLEAR
!!! PLEASE READ ALL CAUTION LABELS FIXED TO THE PRODUCT !!!**

Warning:

- We recommend using Best Bars Ltd trunk strap Part No. 7149 on all Ezi Grip racks.
 - Maximum load 75kg

Manufactured By BEST BARS Ltd, Auckland New Zealand
0800bestbars * sales@bestbars.co.nz * www.bestbars.co.nz

Accessory Part Number: 7271C	Issue Date: 15.11.2007	Page : 2 of 3
Fitting Instruction Part Number:7282C/7283C/7292C/7292C	Issue: 5	

Full Assembly

15:11:2007

EZI-GRIP SPARE WHEEL OFFSET MOUNT BIKE RACK
ASSEMBLY DRAWING

SHEET 2 OF 2

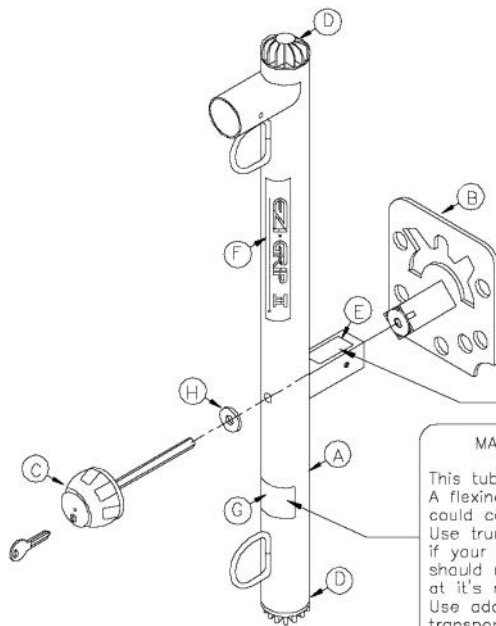

PARTS & FASTENING LIST

(A)	RISER TUBE	(7271C) x1
(B)	PROFILE MOUNT	(7281C) x1
(C)	LOCK PIN WITH KEY	(04F7) x1
(D)	RISER TUBE CAP (BLUE)	(7037) x2
(E)	CAUTION LABEL (RISER)	(L011) x1
(F)	EZI-GRIP LABEL	(7927) x1
(G)	LOAD CAUTION LABEL	(7041) x1
(H)	M12 FLAT WASHER	(026S) x1

WARNING
Always make sure the inner tube is visible through this hole, to prevent over-extension of this unit.
◀ Always ensure the two spare wheel tyre straps are in place and securely fastened. ▶

MAXIMUM TONGUE LOAD 75Kg/165lb

This tube must be vertical at all times. A flexing, bent towbar or loose rack could cause this tube to bend. Use trunk strap Part number: 7149 if your towbar flexes. The towbar should not flex more than 10mm at it's most rearward point. Use additional shock cords when transporting bicycles. Periodically check tightness of rack and clamps. Ensure the ezi safety clip in place, when not using locking device.

© COPYRIGHT
BEST BARS LTD

No: 7271C

REVISION: 2

15:11:2007

EZI-GRIP SPARE WHEEL VERTICAL MOUNT BIKE RACK
ASSEMBLY DRAWING

SHEET 2 OF 2

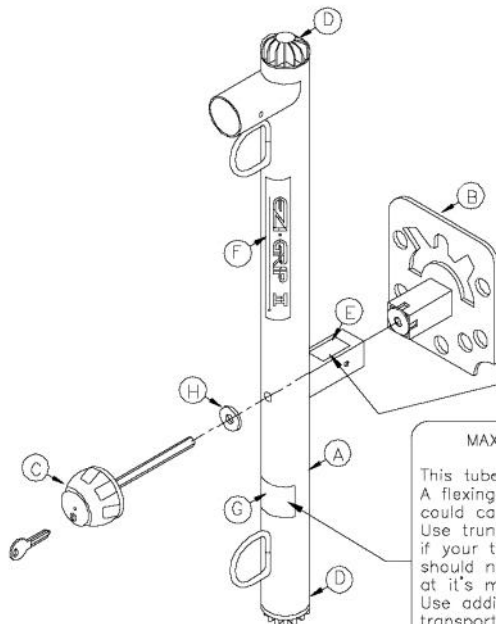

PARTS & FASTENING LIST

(A)	RISER TUBE	(7271C) x1
(B)	PROFILE MOUNT	(7291C) x1
(C)	LOCK PIN WITH KEY	(04F7) x1
(D)	RISER TUBE CAP (BLUE)	(7037) x2
(E)	CAUTION LABEL (RISER)	(L011) x1
(F)	EZI-GRIP LABEL	(7927) x1
(G)	LOAD CAUTION LABEL	(7041) x1
(H)	M12 FLAT WASHER	(026S) x1

WARNING
Always make sure the inner tube is visible through this hole, to prevent over-extension of this unit.
◀ Always ensure the two spare wheel tyre straps are in place and securely fastened. ▶

MAXIMUM TONGUE LOAD 75Kg/165lb

This tube must be vertical at all times. A flexing, bent towbar or loose rack could cause this tube to bend. Use trunk strap Part number: 7149 if your towbar flexes. The towbar should not flex more than 10mm at it's most rearward point. Use additional shock cords when transporting bicycles. Periodically check tightness of rack and clamps. Ensure the ezi safety clip in place, when not using locking device.

© COPYRIGHT
BEST BARS LTD

No: 7271C

REVISION: 2

Accessory Part Number: 7271C

Issue Date: 15.11.2007

Fitting Instruction Part Number: 7282C/7283C/7292C/7292C

Issue: 5

Page : 3 of 3